

# TRANSPORT EQUIPMENT FOR PRECAST ELEMENTS

The handling of prefabricated elements in the factory, due to their size, weight and specific characteristics, requires special attention and the use of specific equipment that can ensure maximum safety, stability and speed of operation.

While for a prefabrication plant the best solution is always represented by the possibility of having efficient bridge or gantry cranes, very often the operational needs go beyond the simple use of these means. Often in fact in the storage areas of the products, due to operational needs or for expansion, the normal cranes are unable to cover the service and it is necessary to moving the products by other means.

**CT Group**, through the great experience acquired over years of specific activity in the sector of the group's companies, is able to present a complete set of tested and safe equipment that guarantees the best response to the needs of the prefabrication industry. The continuously expanded and improved program now features lifting, handling and transport equipment that are the result of detailed knowledge of the problems of prefabrication.

**CT Group** therefore proposes this range:

- Beam or lattice lifting beams.
- Trailed and motorized trolleys on wheel or rail.
- Wheeled trolleys.

In addition to the equipment catalogued, **CT Group** can obviously respond to the most different needs with specific customized projects to meet the requests and needs in this area.

# TOWED EQUIPMENT

A complete and versatile range of **CTM by CONTEC srl** models that meet different needs and can be easily towed by vehicles in the factory.

## CTM60P

For the transport of panels, columns or other types of products with a length of less than 13m, trailers are available with platforms that can be equipped with accessory structures for stabilizing loads. The standard model CTM60P has a 250x1300cm frame with a maximum capacity of **6.000kN** evenly distributed. Other dimensions on request. The 8 wheels with super-elastic anti-puncture tires are mounted on tilting trucks.

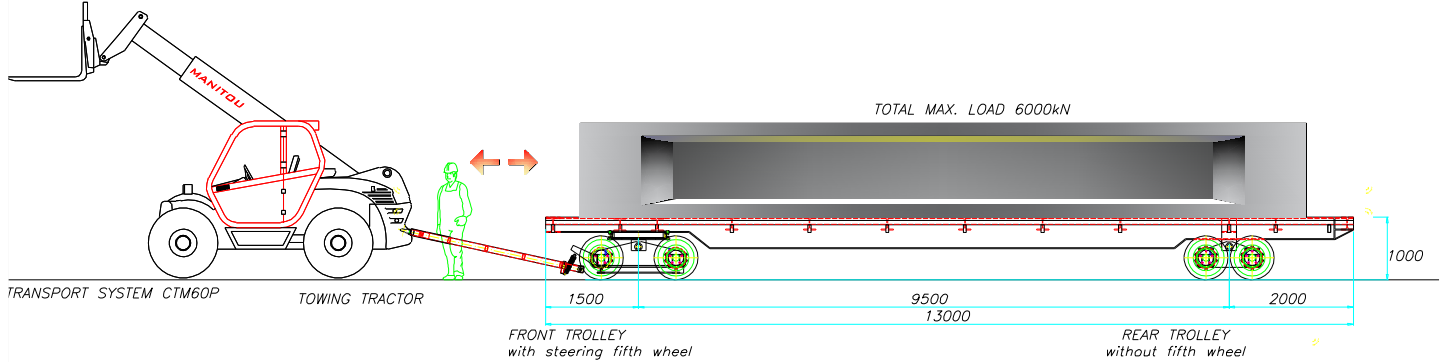

## CTM60TT

The two 4-wheel trolleys with super-elastic tires are connected by a special rudder with a telescopic structure that allows them to vary in length from 8 to 18m. The connection always available allows a fast handling even when the trolley is unloaded. The front trolley, equipped with an upper fifth wheel for supporting the load, allows an easy steering. Max capacity **6.000kN** with support on two trolleys.



TOTAL MAX. LOAD 6000kN

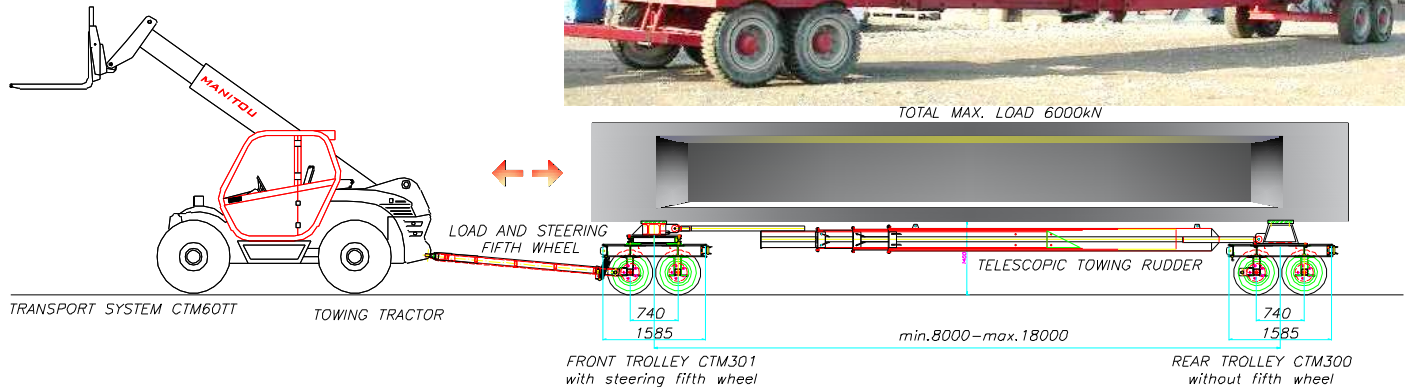

## CTM301+300

The system includes a front trolley equipped with a load support crosspiece mounted on a fifth wheel to allow easy steering during towing. The system allows the transport of up to **6,000kN** distributed on two trolleys. A version with a maximum overall capacity reduced to **3,000kN** is also available on request.



TOTAL MAX. LOAD 6000kN

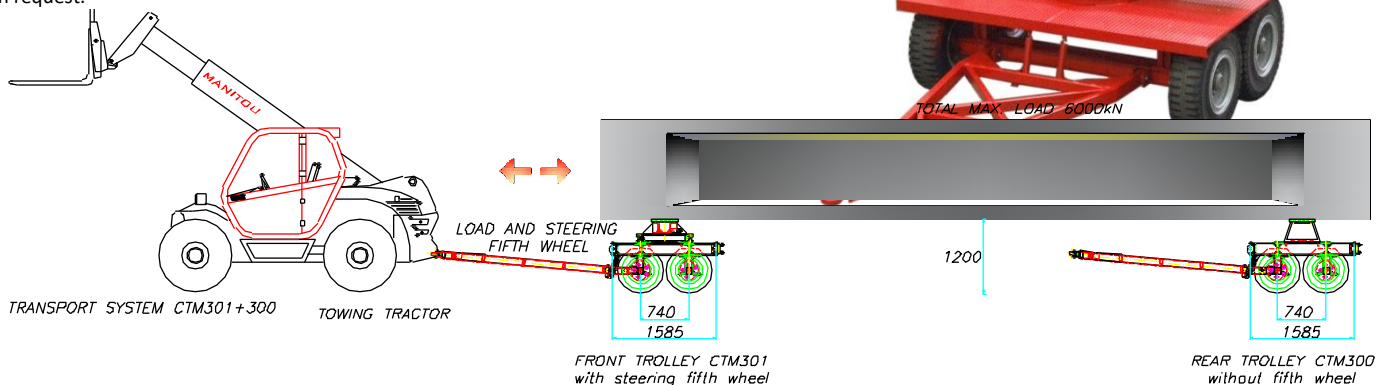

## CTM301+302H

In this system, which is an evolution of the previous one, the rear trolley is equipped with a double fifth wheel, respectively for steering and loading. With this equipment it is possible to carry out maneuvers with a larger turning radius than the previous version thanks to the second steering wheel which can be hydraulically operated with a hydraulic device operated by an operator following the load. The hydraulic system includes a special electro-hydraulic control unit powered by a pair of batteries. The system allows the transport of up to **6,000kN** distributed on the two trolleys. A version with a maximum overall capacity reduced to **3,000kN** is also available on request.

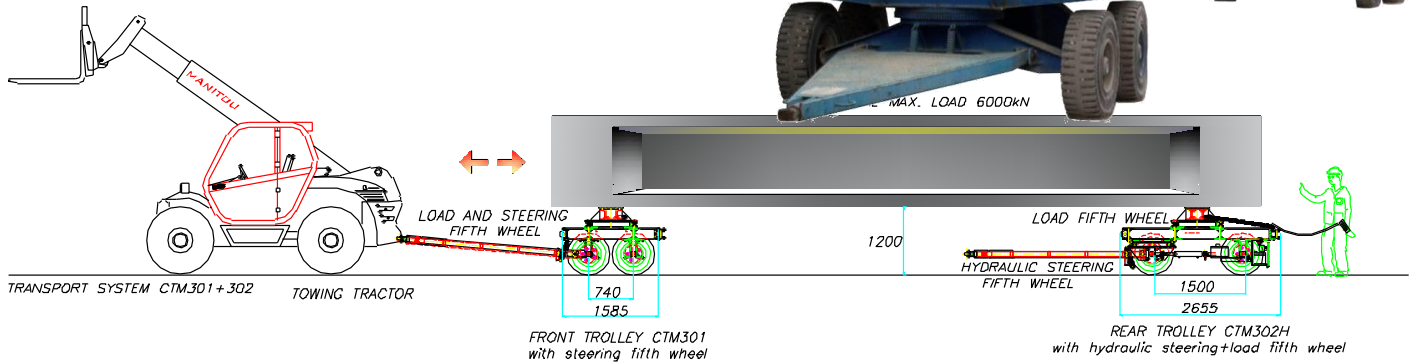

## CTM502+500

With a useful capacity of **10,000kN**, a second fifth wheel is mounted on the front axle to facilitate steering.

The rear trolley is instead equipped with a simple support crosspiece. Due to the presence of the double front fifth wheel, reversing maneuvers must be performed only when the steering axis is aligned with that of the trolley. The system allows the transport of up to **10,000kN** distributed on the two trolleys.

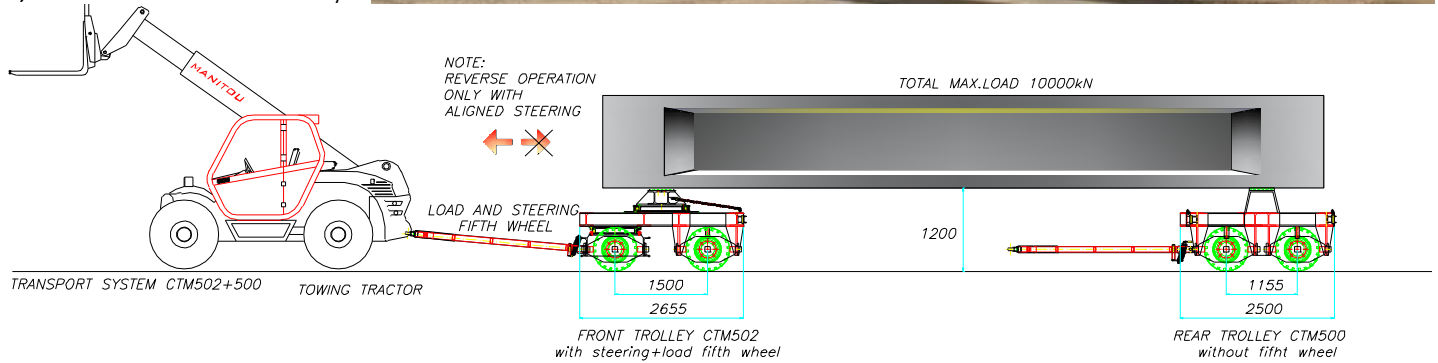

## CTM502+502H

The maximum possible steering is obtained with the use of double fifth wheels on both trolleys; the steering of the rear trolley takes place with hydraulic power steering operated by the operator who follows the load. Due to the presence of the double front fifth wheel, reversing maneuvers must be performed only when the steering axis is aligned with that of the trolley. The system allows the transport of up to **10,000kN** distributed on the two trolleys.

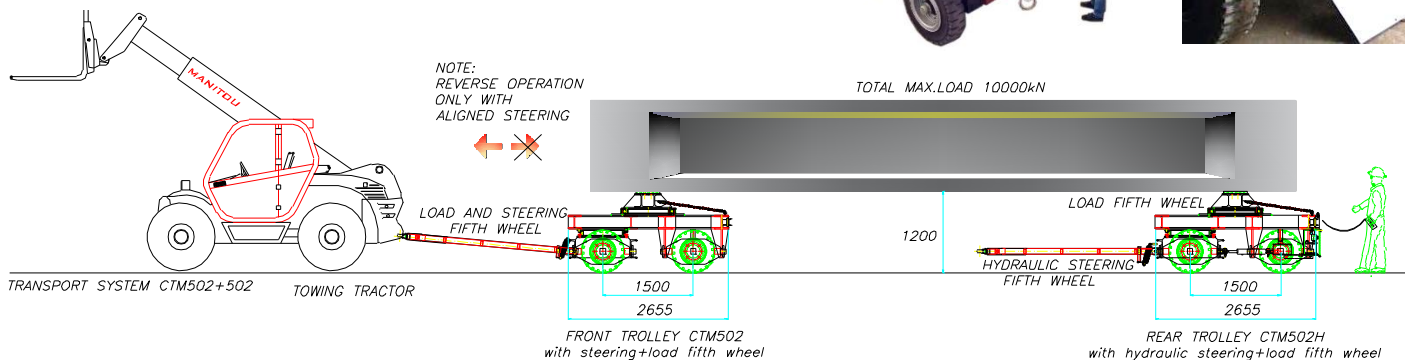

# MOTORIZED EQUIPMENT

The motorized transport systems, even in the face of greater investments, allow to exclude the use of towing vehicles managed by another operator. Having autonomous motorization, they reduce handling times and with the availability of being able to expand the range of action, they allow for larger storage areas or located in different areas.

The possibility of also having full-electric ecological motorizations allows them to be used even in closed environments where the fumes from heat engines cannot be allowed. The **CT Group** range, thanks to **ASCOM** and **ABI-Trailers** experiences, meets the most different needs of use.

## PT30DH/PT30FE by ABI-TRAILERS spa

- **Capacity Tons 35.** Trailer dimensions 8.000x2.500mm. Variable height 1135-1455mm. Translation speed (empty-full) up to 2,5-1,6 Km/h
- Exceedable slope with full load **7%**. Independent front /rear/crab steering system 35°. Independent front and rear lifting system,
- All wheel groups are equipped with gas accumulator for ground deformation compensation. N. 4 driving wheels, N. 4 steering gear cylinders,
- Double control system: by remote control and by wired remote control
- Thermic Engine (1 unit) YANMAR 3TNV88 29KW Stage 5. Electric Unit (1 unit) 18000W-48VDC-2850 RPM-IP44. Lithium Battery (4 units) 6650W each
- DC/DC Converter 12-24V. INVERTER Gen 4 Size 6. Management SOFTWARE by ABI TRAILERS
- N. 8 coupled superelastic tires on oscillating supports.

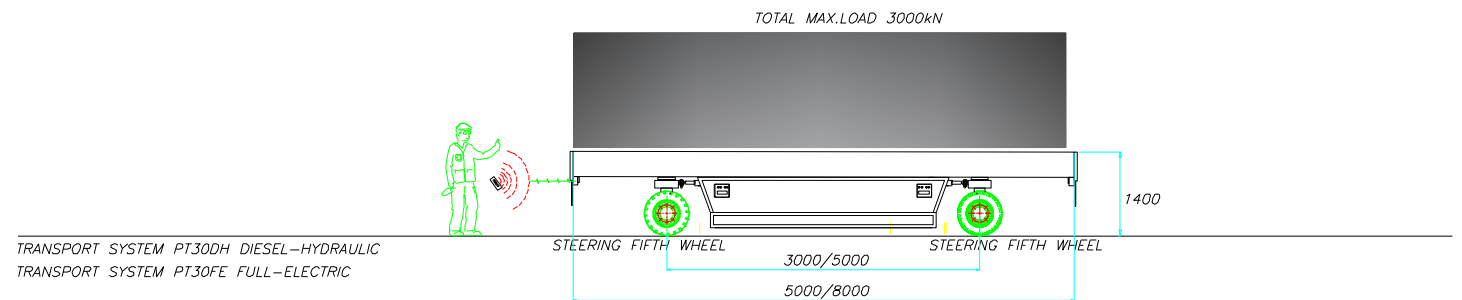

## DT50+CTM500 by ABI-TRAILERS spa & CONTEC srl

- Motor Front Trolley:** Capacity Tons 50. Trailer dimensions 4.000x2.500mm. Variable height 1135-1455mm. Translation speed (empty-full) up to 2,5-1,5 Km/h
- Exceedable slope with full load 3%. Independent front /rear/crab steering system 35°. Independent front and rear lifting system,
  - All wheel groups are equipped with gas accumulator for ground deformation compensation. N. 4 driving wheels, N. 4 steering gear cylinders,
  - Double control system: by remote control and by wired remote control
  - Diesel Engine Perkins 35kW Stage III
  - N. 8 coupled superelastic tires on oscillating supports.
  - Upper loading crosspiece with swinging fifth wheel
- Rear Trolley:** Capacity Tons 50. Trailer dimensions 2.500x2.500mm. Height 1200mm.
- N. 8 coupled superelastic tires on oscillating supports.
  - Raised and fixed load crosspiece

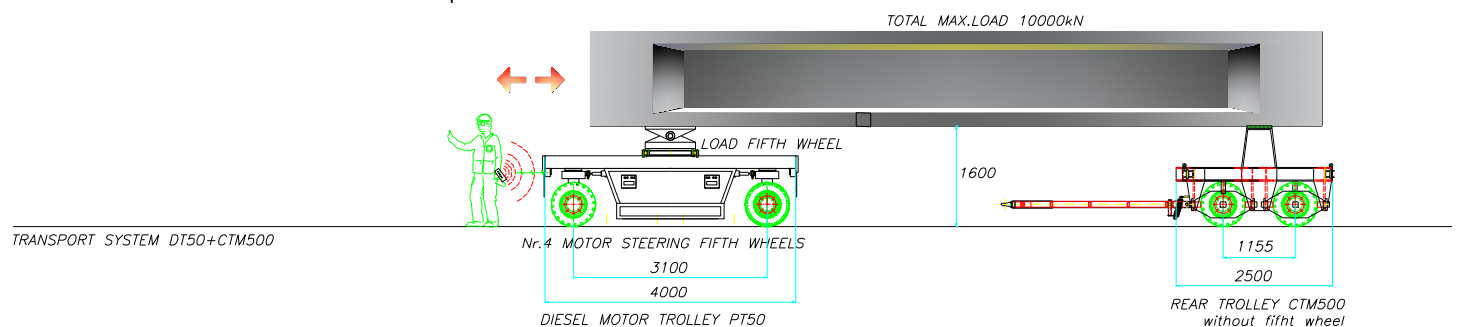

## DT50+CTM502H by ABI-TRAILERS spa & CONTEC srl

**Motor Front Trolley:** Capacity Tons 50. Trailer dimensions 4.000x2.500mm. Variable height 1135-1455mm. Translation speed (empty-full) up to 2,5-1,5 Km/h

- Exceedable slope with full load 3%. Independent front /rear/crab steering system 35°. Independent front and rear lifting system,
- All wheel groups are equipped with gas accumulator for ground deformation compensation. N. 4 driving wheels, N. 4 steering gear cylinders,
- Double control system: by remote control and by wired remote control
- Diesel Engine Perkins 35kW Stage III
- N. 8 coupled superelastic tires on oscillating supports.
- Upper loading crosspiece with swinging fifth wheel

**Rear Trolley:** Capacity Tons 50. Trailer dimensions 2.500x2.500mm. Height 1200mm.

- N. 8 coupled superelastic tires on oscillating supports.
- Front steering fifth wheel and drawbar for connection to the motor trolley
- Hydraulic steering system with battery electric group; operator control with pendant pushbutton
- Upper loading crosspiece with fifth wheel

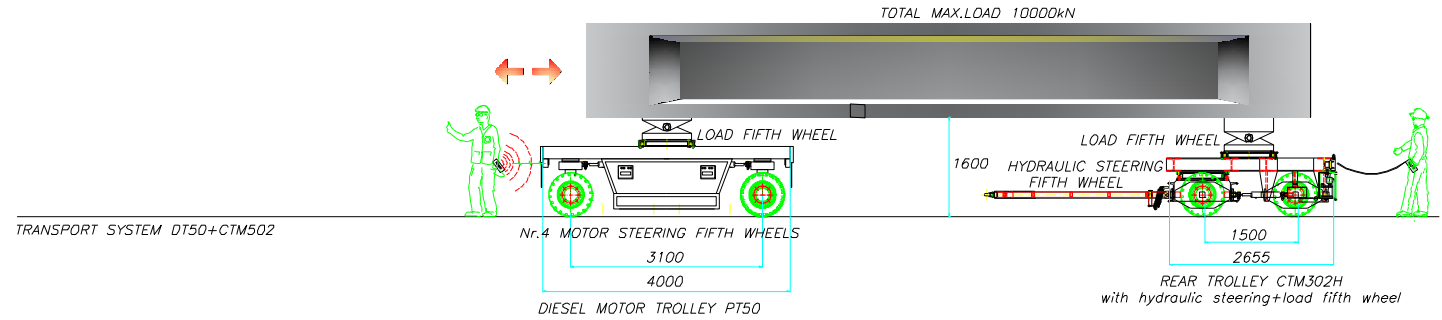

## DT50+DT50 by ABI-TRAILERS spa

With the coupling of two DT50 drive units, the most complete operational possibility is obtained even in confined areas with limited maneuvering space. The two units are managed in a completely combined way with a total control of the movements by a single operator. Total capacity 10-000kN.

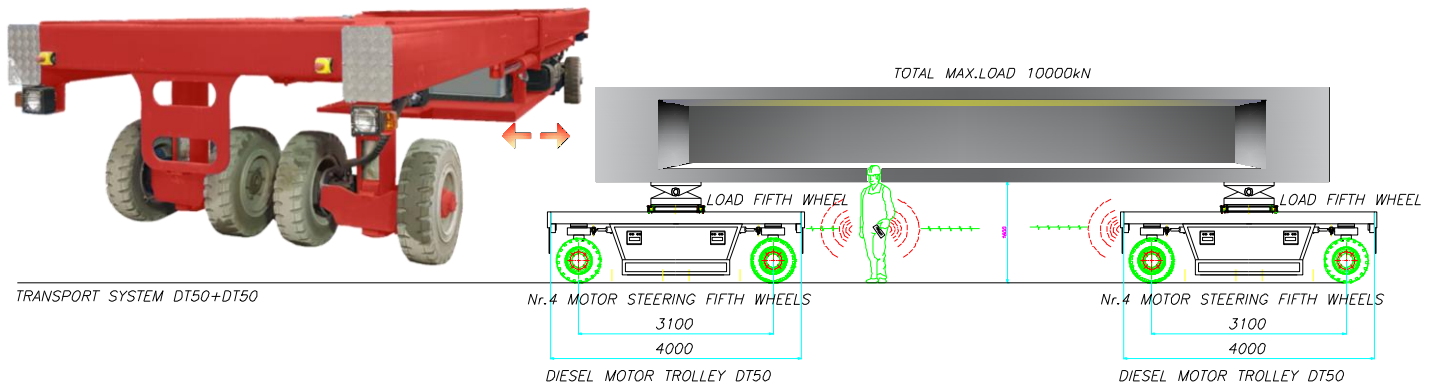

## CTM100RE by CONTEC srl

The RE System provides for the sliding of the pair of trolleys on special tracks and thanks to the complete full electric power supply, it allows the movement of heavy loads in complete safety and without harmful emissions even within closed departments.

For the transport of panels or vertical structures, a complete range of accessory elements is available to stabilize the load.

Total capacity 10,000kN; power supply with electric cable reel.

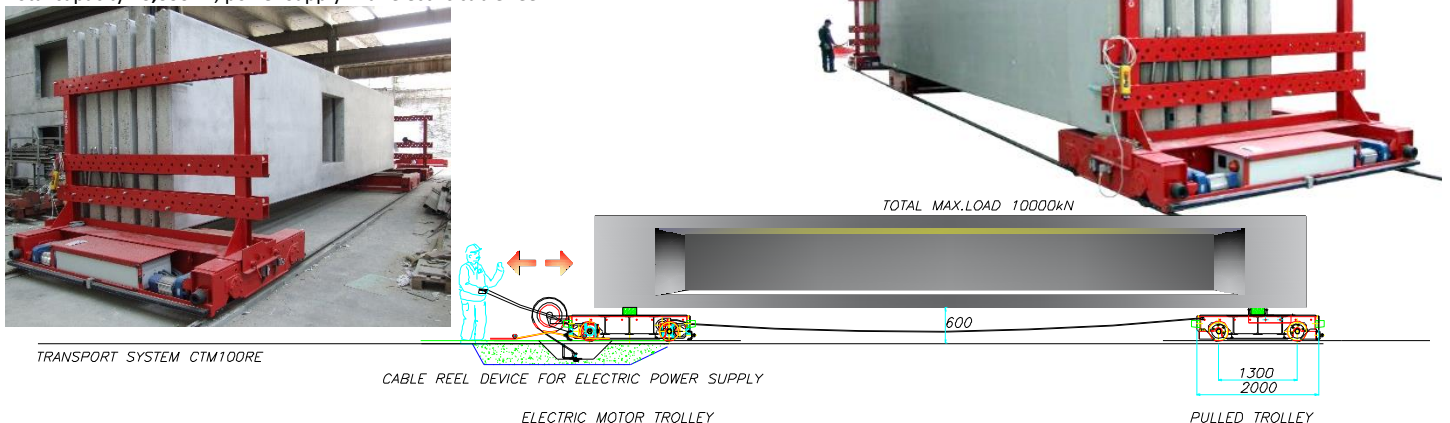

# STRADDLE CARRIER CLS38 by ASCOM spa

- Overall Lifting Capacity **38 Tons**
- **Under Spreader Lifting Capacity 35 Tons (distributed on four points)**
- Minimum Inner Clear Width A) mm 7.000
- Track (Transversal Wheelbase) B) mm 8.000
- Overall width C) mm 9.640
- Overall height @ void D) mm 9.9900
- Inside clear height E) mm 8.500
- Longitudinal Wheel-base F) mm 8.000
- Overall length at tyres G) mm 10.300
- Trolleys transverse travelling N) 5.000mm (± 2.500)
- Under Spreader Height UHH mm 7.250
- Number of winches/trolleys/lifting points 1+1
- Max. lifting capacity for each winch t.37.5
- Dead-weight (spreader included) metric t41 Approx.
- Main Travel Speed at full load ranging from zero to Km/h 3
- Hoisting Speed at full load ranging from zero to m/min 4
- Trolleys transversal speed at full load ranging from zero to m/min 12
- Nominal vertical gradient at full load (reduced speed) %5
- New Brand OTR Tires type 16.00 - 25 / high abrasion resistance
- Traction Wheels N°4-wheels steering system through hydraulic cylinders
- Wireless Remote Control including an auxiliary emergency unit
- Engine type \ Pollution compliance DIESEL \ Stage IV

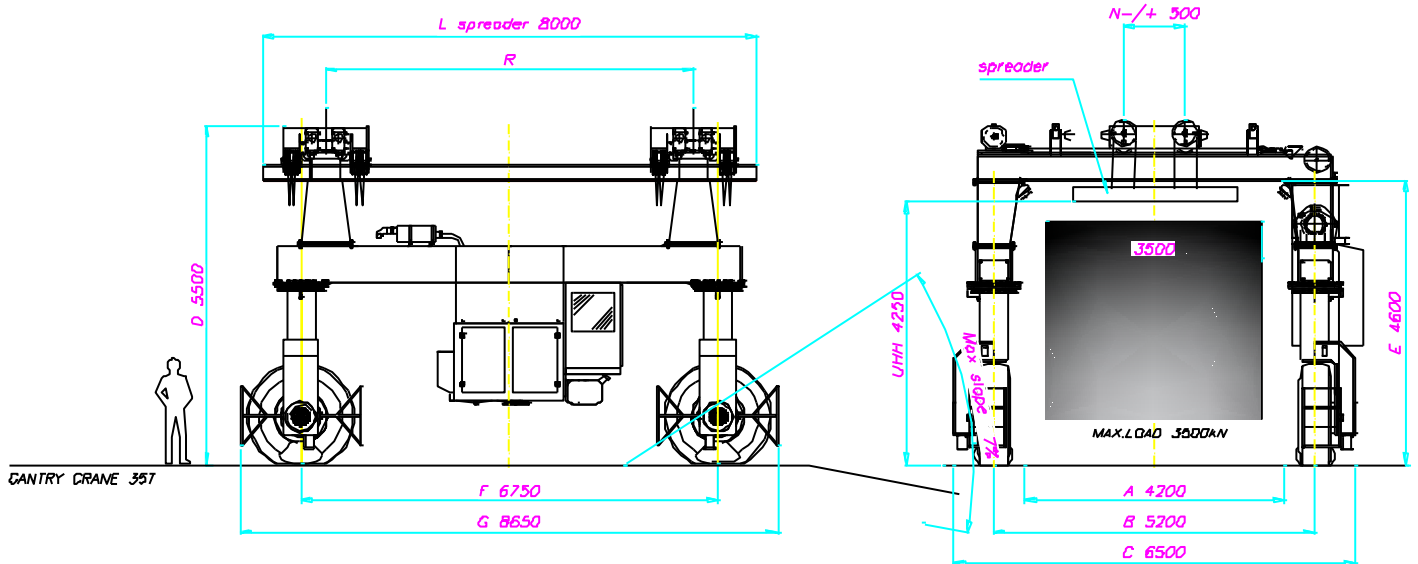

# STRADDLE CARRIER CLS75 by ASCOM spa

- Overall Lifting Capacity **75 Tons**
- **Under Spreader Lifting Capacity t35 (distributed on four points)**
- Minimum Inner Clear Width A) mm 4.200
- Track (Transversal Wheelbase) B) mm 5.200
- Overall width C) mm 6.500
- Overall height @ void D) mm 5.500
- Inside clear height E) mm 4.600
- Longitudinal Wheel-base F) mm 6.750
- Overall length at tyres G) mm 8.650
- Trolleys transversal travelling distance N) mm 1.000 (± 500)
- Under Spreader Height UHH mm 4.250
- Number of winches 2. Number of lifting trolleys 2
- Dead-weight (spreader included) metric t25 Approx.
- Main Travel Speed at full load ranging from zero to Km/h 2.10
- Secondary Travel Speed (load ≤ 10 t) ranging from zero to Km/h 3.00
- Hoisting Speed at full load ranging from zero to m/min 3.60
- Trolleys transversal speed at full load ranging from zero to m/min 8.00
- Nominal vertical gradient at full load (reduced speed) %7
- New Brand OTR Tires type 16.00 - 25 / high abrasion resistance
- Traction Wheels N°4-wheels steering system through hydraulic cylinders
- Wireless Remote Control including an auxiliary emergency unit
- Engine type \ Pollution compliance DIESEL \ Stage V
- Option for **full electric version**

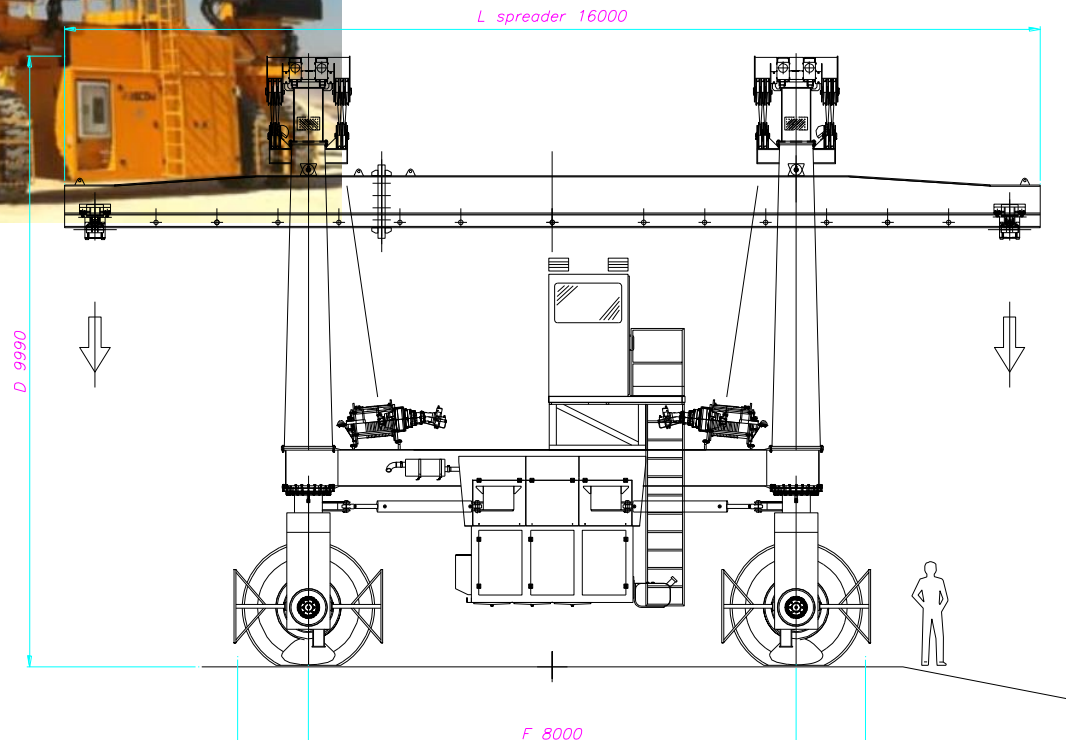
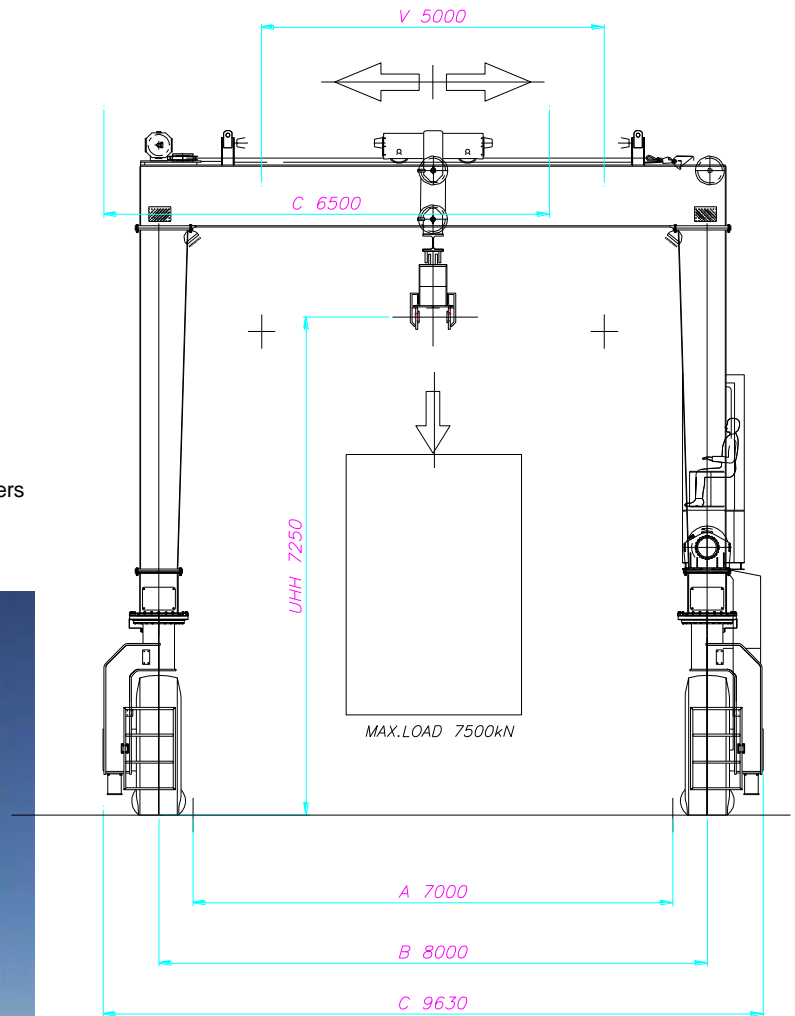



Made in ITALY

# CT

CONCRETE TECHNOLOGY GROUP

---

**CONTEC** SRL  
 Formworks & Prestressing Equipment

**VETORI** S.r.l.

**ASCOM** ITALIA  
 HANDLING EQUIPMENT SPECIALIST

**ABI TRAILERS** ITALIA  
 MOVING SOLUTIONS SPECIALISTS

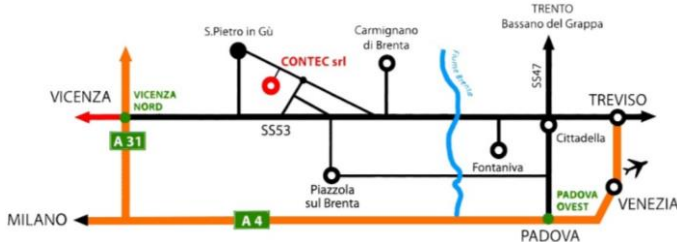

*Note: Images from the CONTECsrl, Abi-Trailers spa and Ascom spa archives*

All information contained in this document is provided for information purposes only and CONTEC srl reserves the right to alter equipment and specifications based on possible evolution of the product and/or market conditions at the time of the definition of the order

## CONTECsrl is a partner of CONCRETE TECHNOLOGY GROUP

**Contec srl** 35010 Carmignano di Brenta (Padova) Italy - Viale Industria e Artigianato 26c Tel.0039 0499431317